

NESTiG

# The Spyglass Shelf



Please read all instructions before assembly  
and use of product!

Lisez toutes les instructions avant  
d'assembler et d'utiliser le produit!

# Welcome to the Nestig World!

## Our Warranty

Our products come with a limited two year warranty! We do our best to ensure everything arrives in perfect shape, but if anything arrives damaged, missing, or defective, our Customer Experience team is here to help.

Just email us at [hello@nestig.com](mailto:hello@nestig.com) and we'll be glad to assist!

For more information on our warranty, visit:

<https://www.nestig.com/pages/warranty-policy>

# Bienvenue dans le monde de Nestig!

## Notre Garantie

Nos produits sont accompagnés d'une garantie limitée de deux ans! Nous faisons de notre mieux pour que tout arrive forme parfaite, mais si quelque chose arrive endommagé, manquant ou défectueux, notre équipe Expérience Client est là pour vous aider.

Envoyez-nous un e-mail à [hello@nestig.com](mailto:hello@nestig.com) et nous serons heureux de vous aider!

Pour plus d'informations sur notre garantie, visitez:

<https://www.nestig.com/pages/warranty-policy>

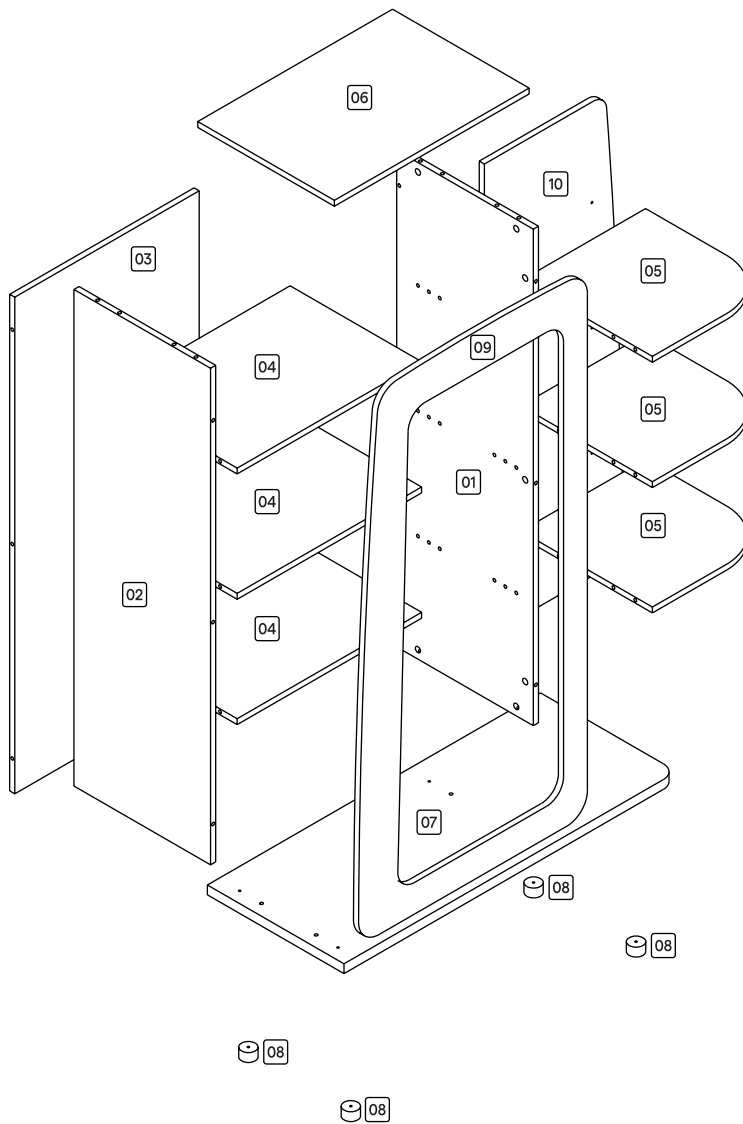

Item	Description	Quantity
01	Right Side	01
02	Left Side	01
03	Back Panel 3	01
04	Shelf 4	03
05	Shelf 5	03
06	Top	01
07	Base	01
08	Feet	04
09	Frame	01
10	Back Panel 10	01

Not included: Phillips head screwdriver and hammer



Phillips head screwdriver

### How to use the cam lock nut + bolt

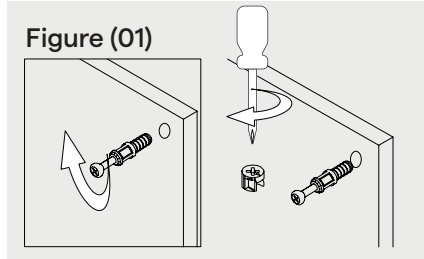

### Hardware list

A Qty. 32

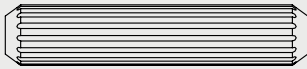

8x40mm dowel

B Qty. 20

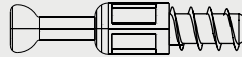

Cam lock bolt

C Qty. 32



Cam lock nut

D Qty. 06

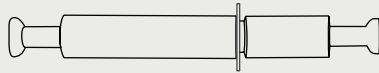

Double pin

E Qty. 06

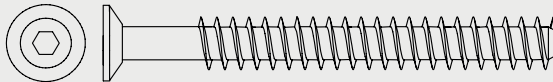

5x60mm screw

F Qty. 04

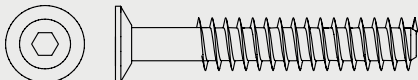

5x40mm screw

G Qty. 01

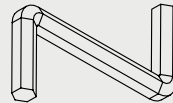

Z wrench

H Qty. 32



Adhesive hole cover

## Anti-tipping kit

I Qty. 02

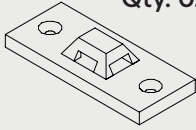

Anti-tipping panel

J Qty. 01



Anti-tipping fastener

K Qty. 02

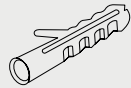

Anchor

L Qty. 02



Anti-tipping 3.5x20mm screw

M Qty. 02

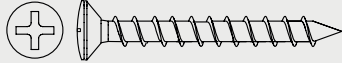

Anti-tipping 4x45mm screw

# STEP 1

01 02

### Figure 1

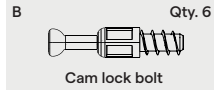

Position piece #2 on a clean and smooth surface. Using a Phillips screwdriver, screw all the cam lock bolts "B" into their respective holes.

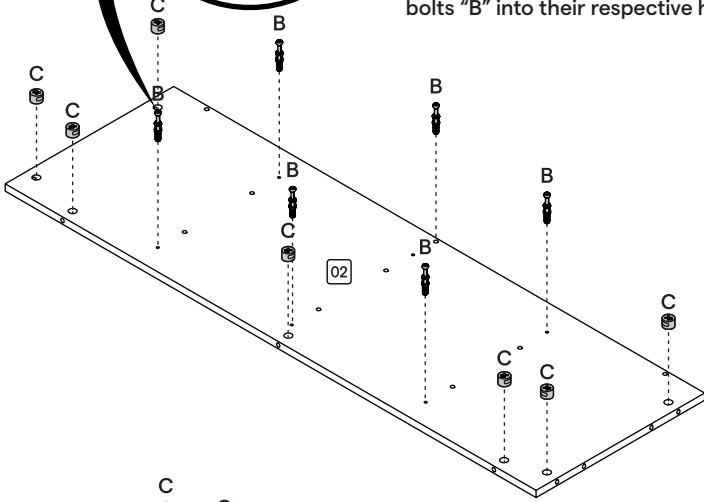

Position the cam lock nuts "C" in their respective holes. Be sure that the arrow on "C" is facing the edge of the piece (see Figure 1).

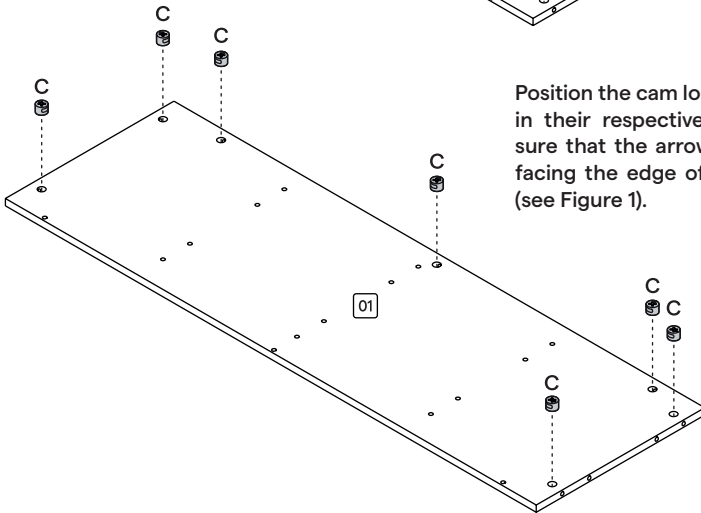

# STEP 2

04 05 06

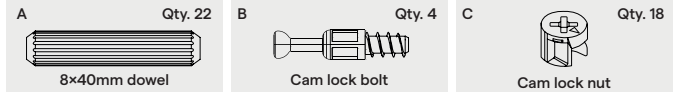

Using a hammer, insert the dowels "A" into the holes in pieces #4, #5 and #6.

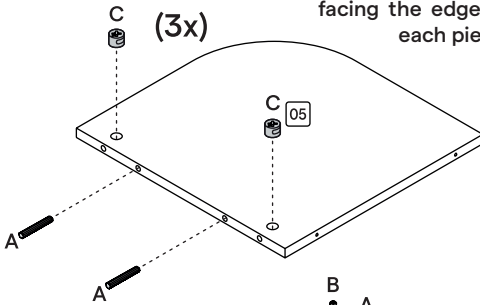
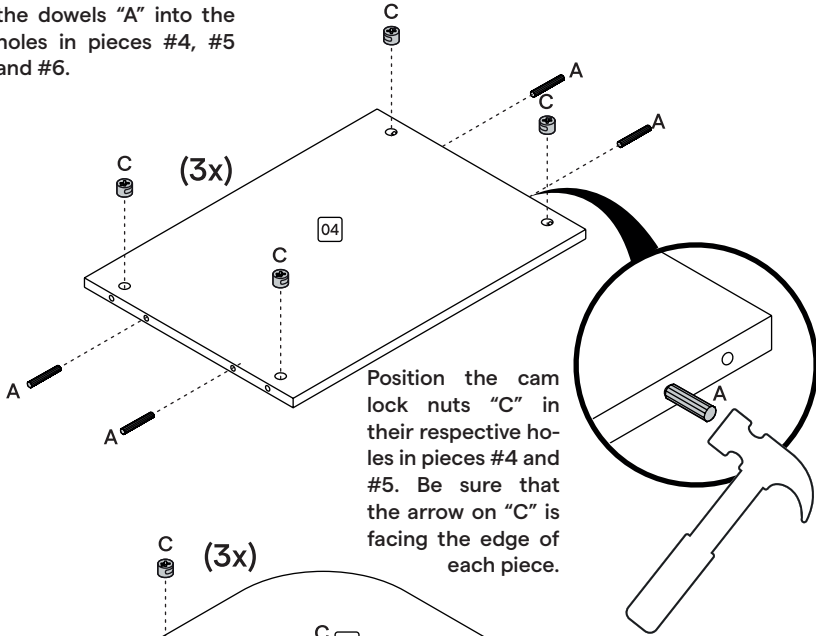

Using a Phillips screwdriver, screw the cam lock bolts "B" into their respective holes in piece #6.

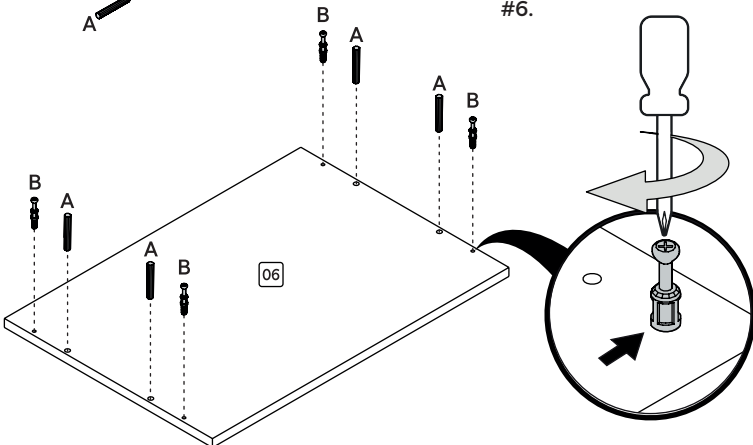

# STEP 3

03 07 09

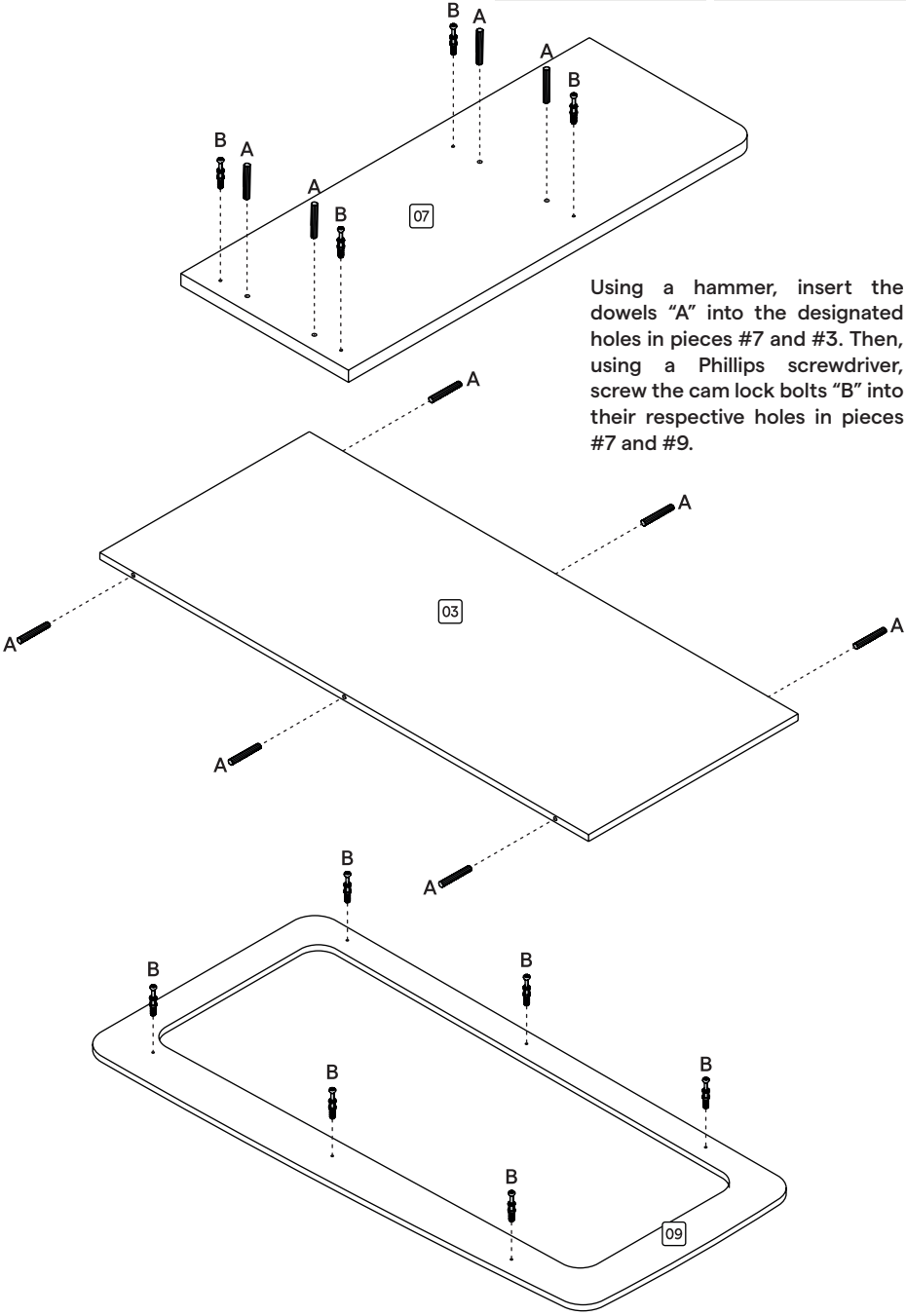
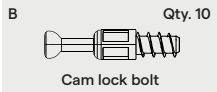
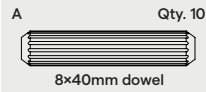

Using a hammer, insert the dowels "A" into the designated holes in pieces #7 and #3. Then, using a Phillips screwdriver, screw the cam lock bolts "B" into their respective holes in pieces #7 and #9.



## STEP 4

01 03

Using another person for help, gently glide the dowels in piece #3 into the denoted holes in piece #1. Avoid sudden movements to keep from damaging the dowels.

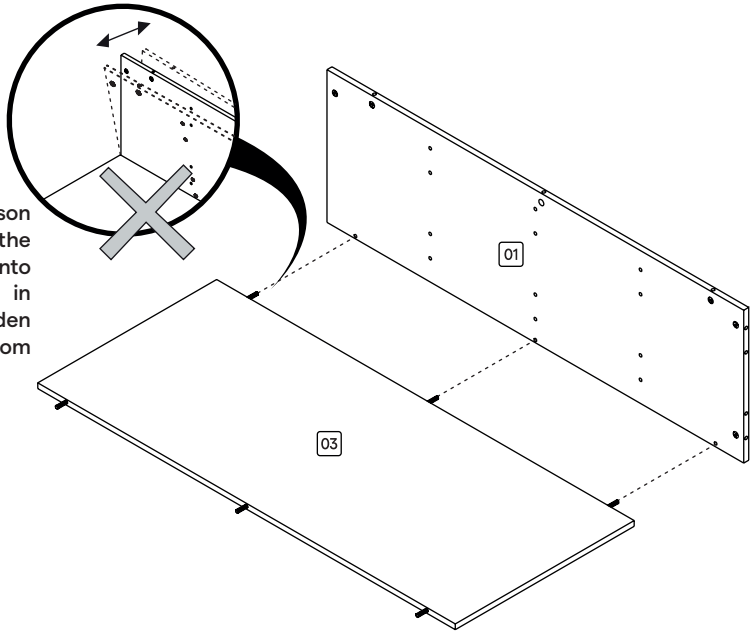

## STEP 5

04 05

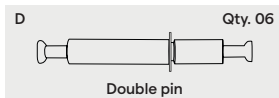

Connect a piece #4 to piece #1 by inserting the double pin "D" into the designated holes and guiding piece #4 into piece #1.

Connect a piece #5 to piece #1 by guiding the dowels in #5 into the holes in piece #1.

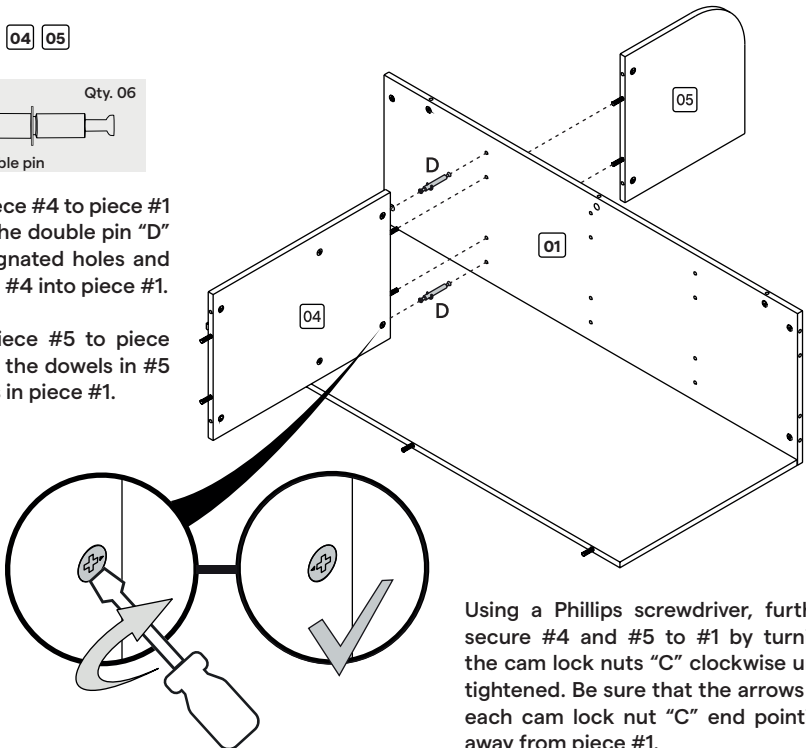

Using a Phillips screwdriver, further secure #4 and #5 to #1 by turning the cam lock nuts "C" clockwise until tightened. Be sure that the arrows on each cam lock nut "C" end pointing away from piece #1.

Repeat step 5 twice more to attach the final two #4 and #5 pieces. Be sure to tighten the cam lock nuts "C".

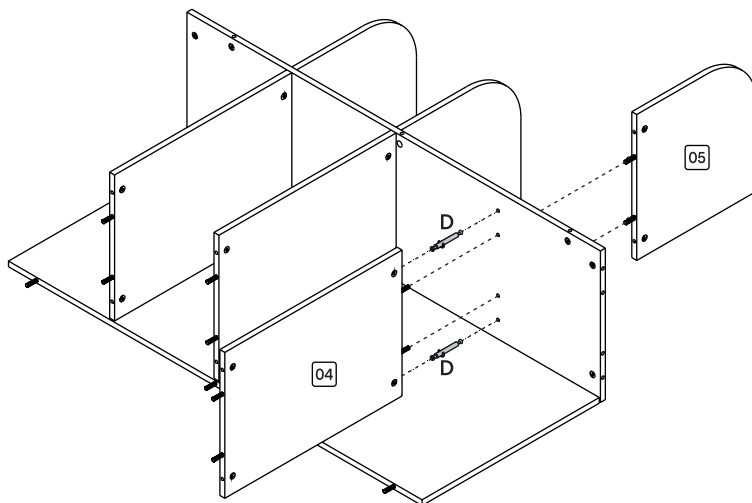
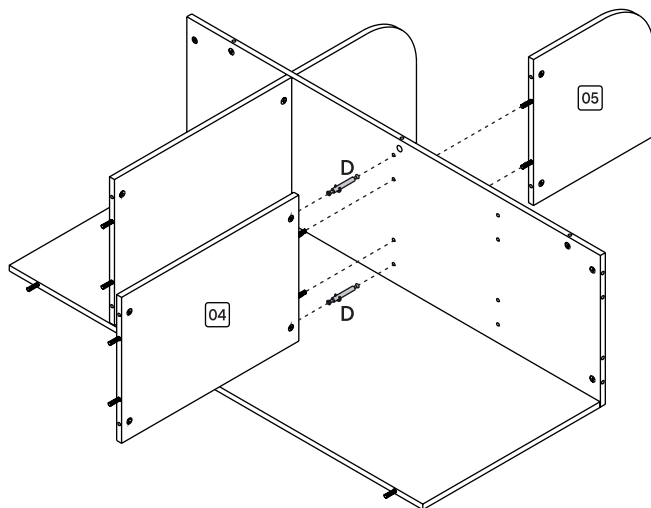

## STEP 6 02

Connect piece #2 to the rest of the structure by guiding the designated holes in #2 into the dowels in the structure.

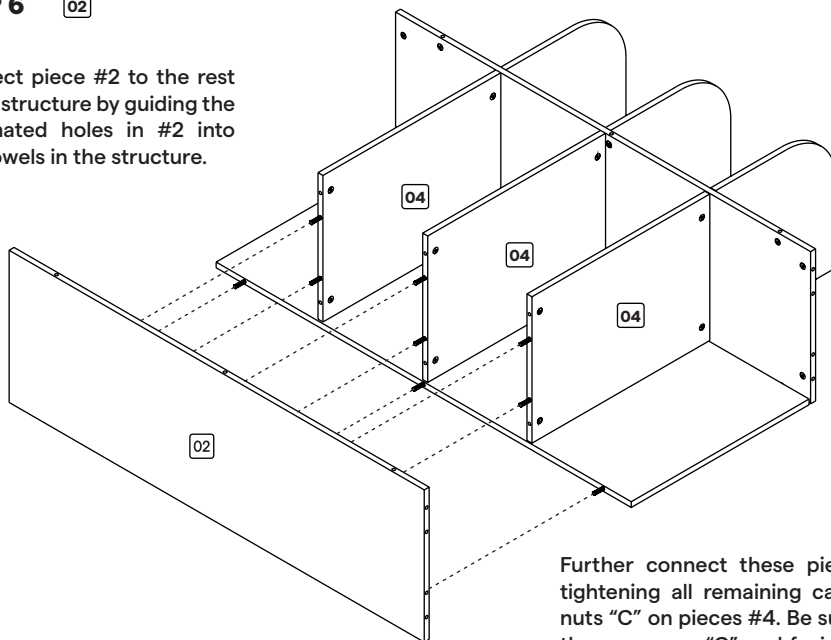

Further connect these pieces by tightening all remaining cam lock nuts "C" on pieces #4. Be sure that the arrows on "C" end facing away from piece #2.

## STEP 7 06

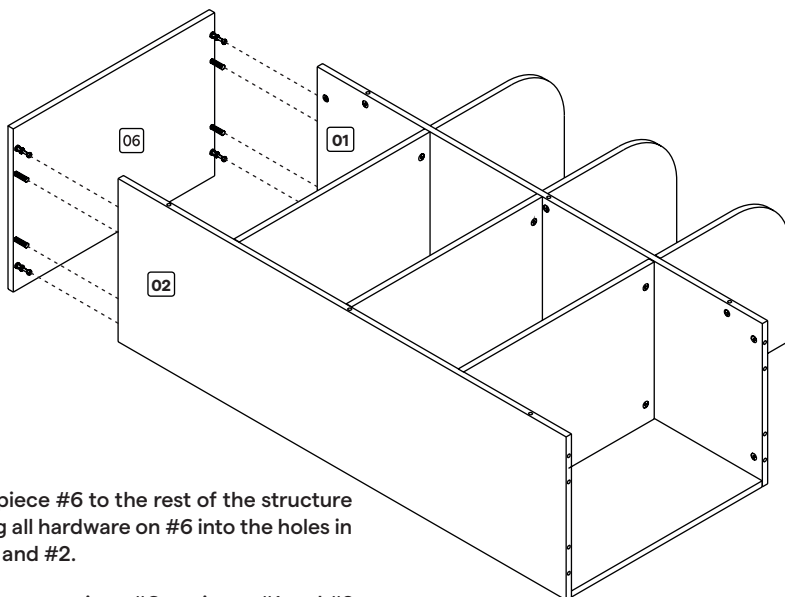

Connect piece #6 to the rest of the structure by guiding all hardware on #6 into the holes in pieces #1 and #2.

Further connect piece #6 to pieces #1 and #2 by tightening the cam lock nuts "C" at the top of pieces #1 and #2. Be sure that the arrows on "C" end facing away from piece #6.

## STEP 8 07

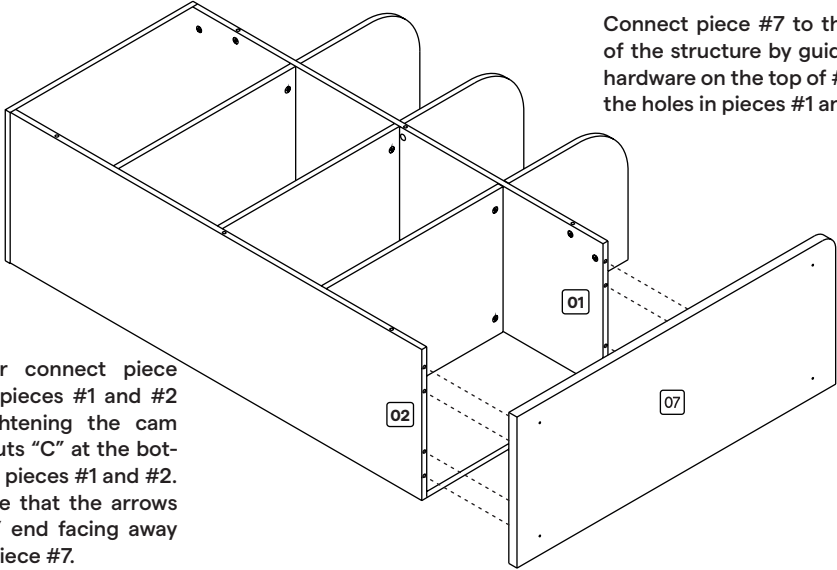

Connect piece #7 to the rest of the structure by guiding all hardware on the top of #7 into the holes in pieces #1 and #2.

Further connect piece #7 to pieces #1 and #2 by tightening the cam lock nuts "C" at the bottom of pieces #1 and #2. Be sure that the arrows on "C" end facing away from piece #7.

## STEP 9 08

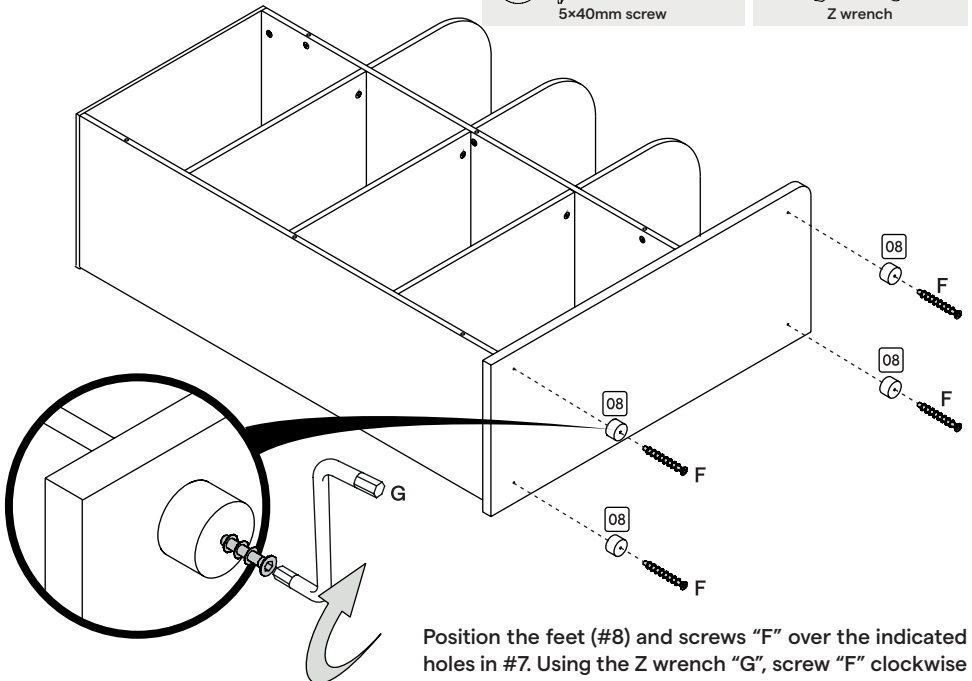
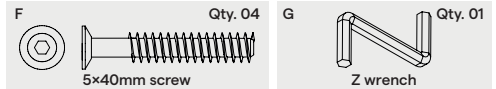

Position the feet (#8) and screws "F" over the indicated holes in #7. Using the Z wrench "G", screw "F" clockwise to attach and tighten the feet.

## STEP 10

With the help of a second person, stand the shelf up on a clean surface.

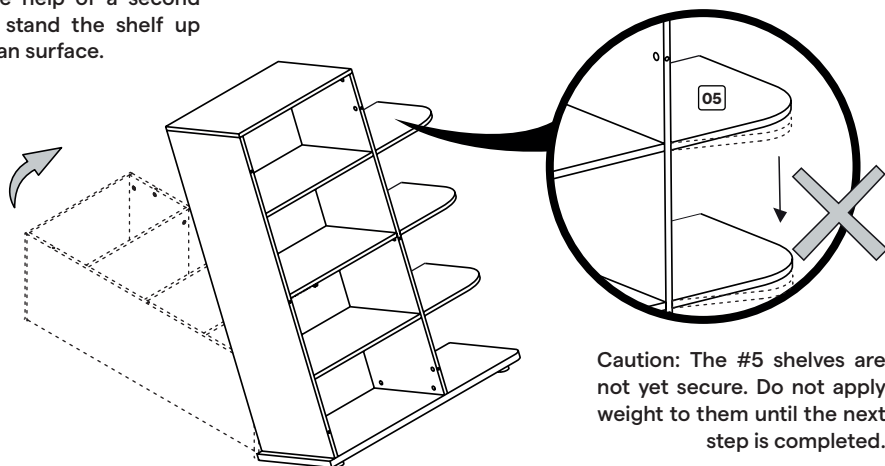

## STEP 11 10

Attach #10 to the structure, using screws "E" and the Z wrench "G", screwing clockwise until tightened.

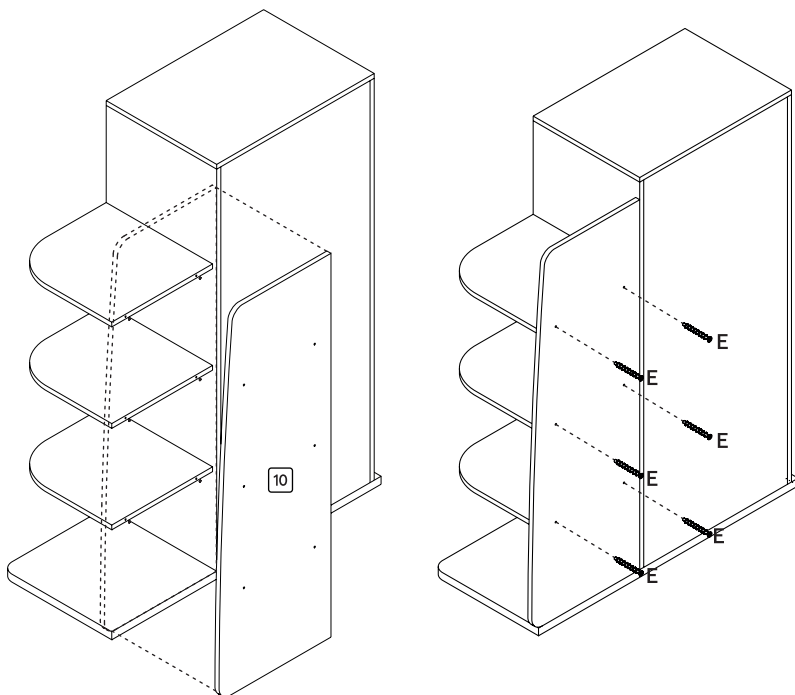
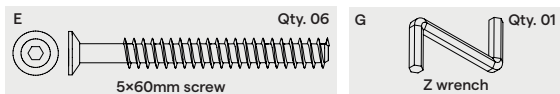

## STEP 12 09

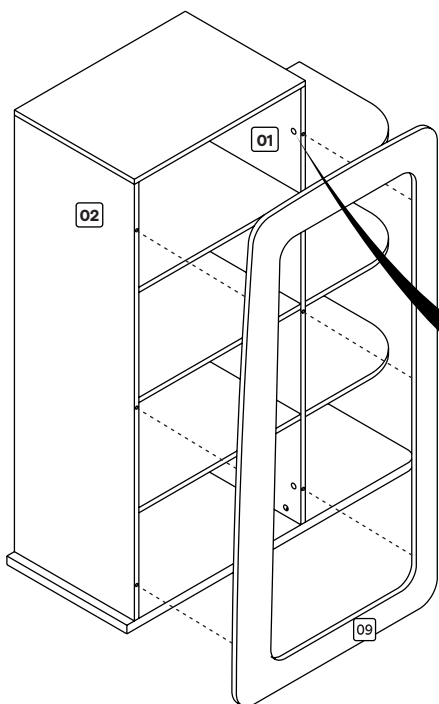

Attach piece #9 to the front of the structure, guiding the hardware on the back of #9 into the holes in #1 and #2.

Further connect the pieces by tightening the cam lock nuts "C" at the front of pieces #1 and #2. Be sure that the arrows on "C" end facing away from piece #9.

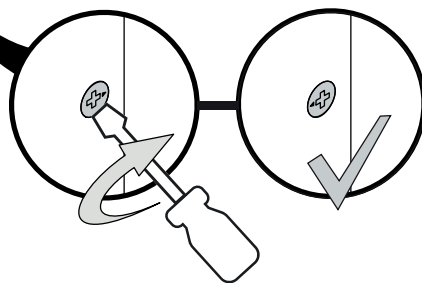

## STEP 13

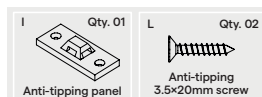
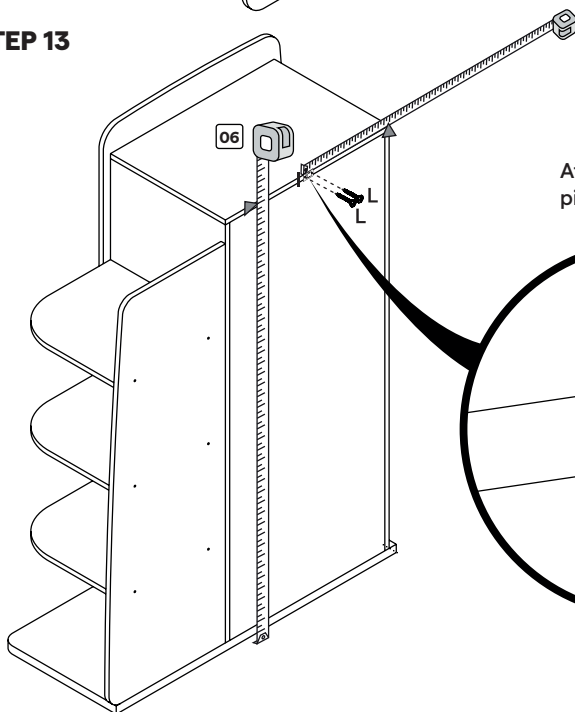

Attach the anti-tipping panel "I" onto piece #6 using screws "L", as shown in the image below.

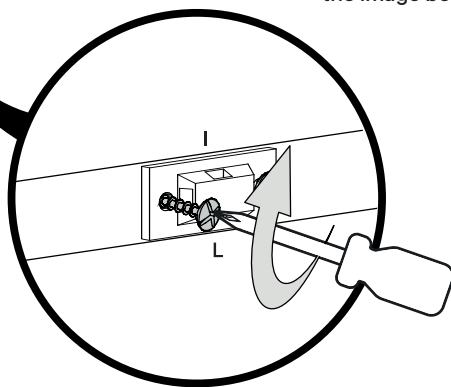

## STEP 14

Position the second anti-tipping panel "I" onto a wall at the same height as the "I" piece attached to the shelf. Drill to create holes in the wall corresponding to the holes in "I".

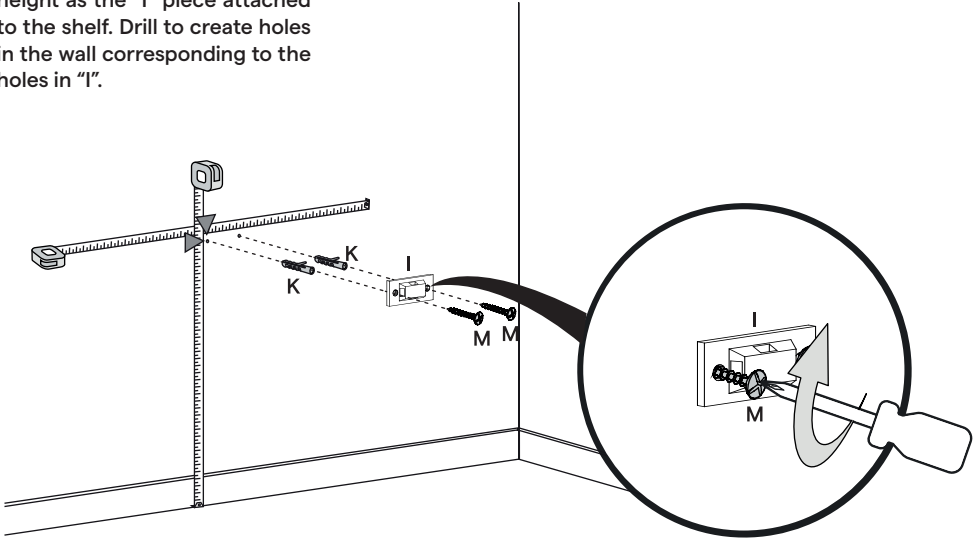
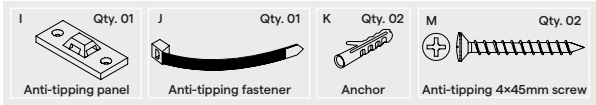

Insert the anchor pieces "K" into the holes in the wall. Then attach the anti-tipping panel "I" to the wall, threading the "M" screws into each anchor "K". Finally, secure the anti-tipping panels "I" to each other using the anti-tipping fastener "J".

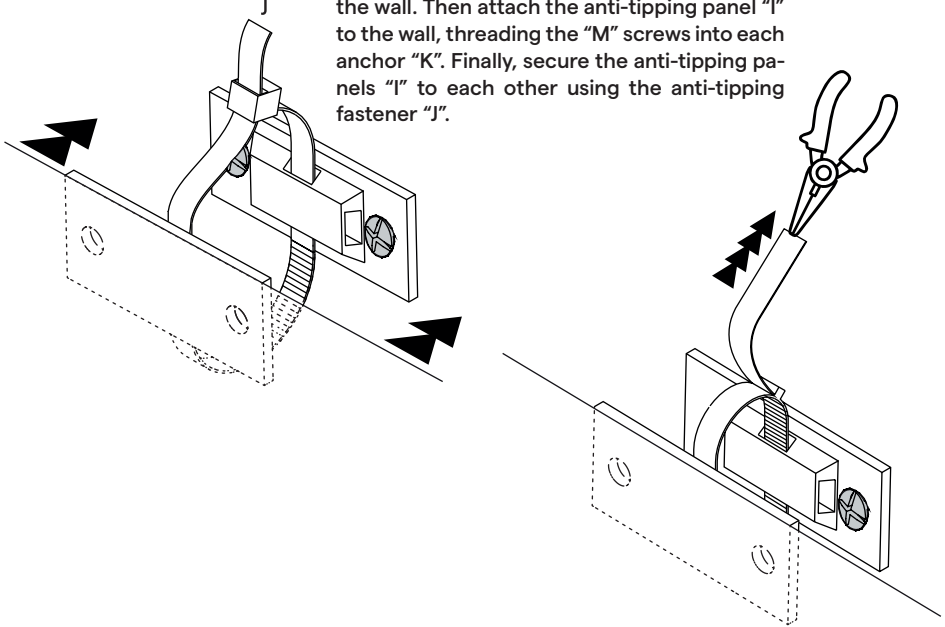

**STEP 15**

H Qty. 32



Adhesive hole cover

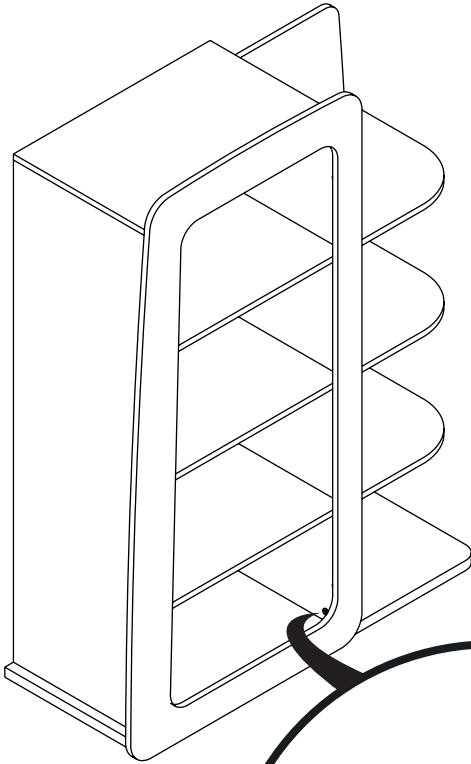

Optional: Cover any holes with the adhesive hole covers "H".

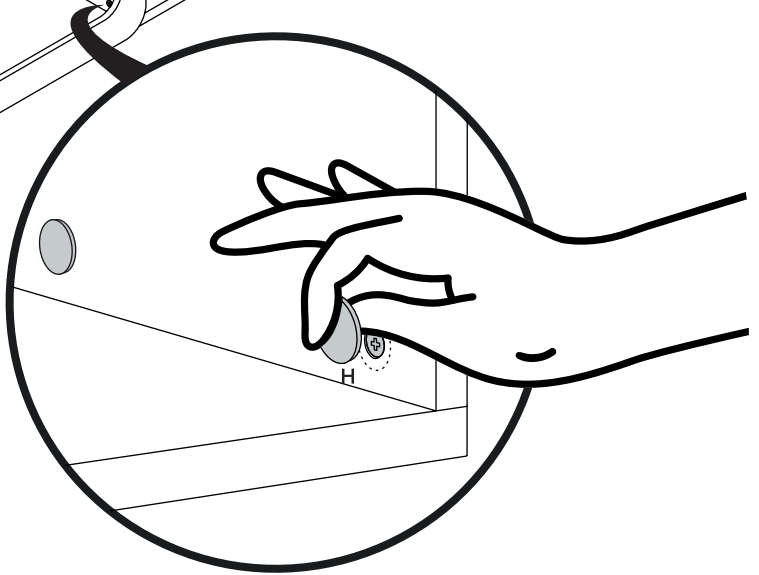



## We're Here to Help!

Our product specialists are on hand to answer any questions, help you set up and use your Nestig products, and bring the nursery you imagine to life:

Email us at [hello@nestig.com](mailto:hello@nestig.com)  
[www.nestig.com/support](http://www.nestig.com/support)  
Monday - Friday | 10am-5pm ET

## Nous sommes là pour vous aider!

Nos spécialistes produits sont à votre disposition pour répondre à toutes vos questions, vous aider à installer et utiliser vos produits Nestig et donner vie à la chambre d'enfant que vous imaginez:

Contactez-nous au [hello@nestig.com](mailto:hello@nestig.com)  
[www.nestig.com/support](http://www.nestig.com/support)  
Lundi - Vendredi | 10h-17h HE



[nestig.com](https://nestig.com)



**Nestig, Inc.**  
[hello@nestig.com](mailto:hello@nestig.com)  
PO Box 1106, New York, NY 10023